

# BMW S 1000 RR '15

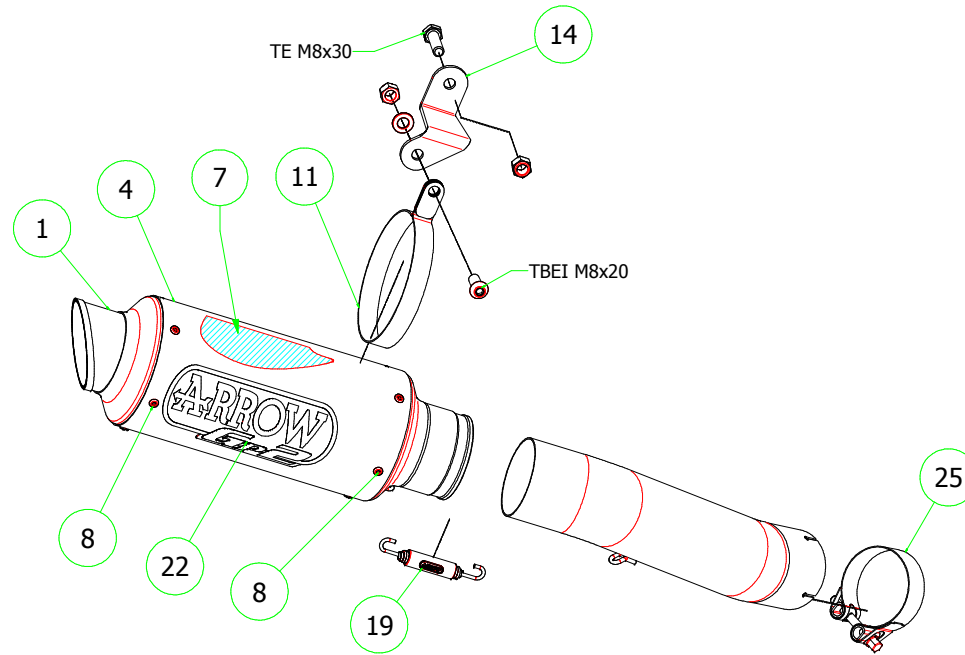

71013GP Racing GP2 ( Titanium )  
71013GPI Racing GP2 ( Nichrom )



71823PK Homologated Titanium (Works)

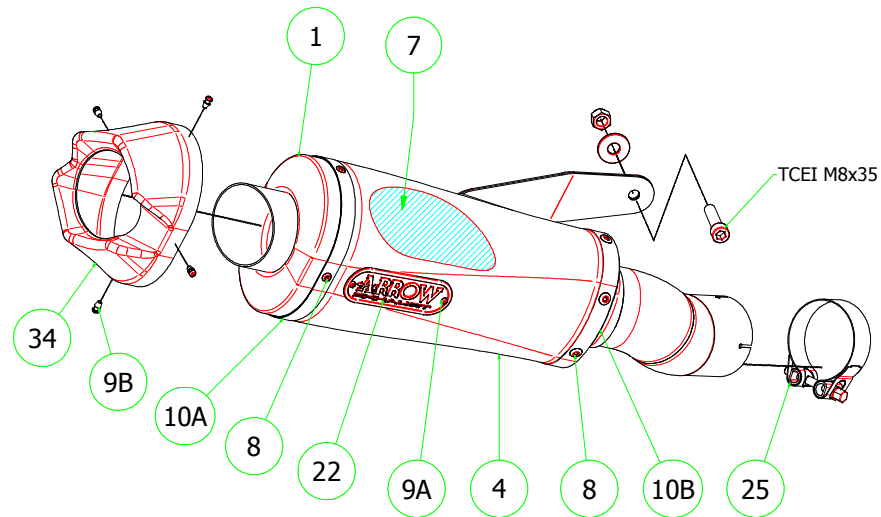

## PARTI DI RICAMBIO / SPARE PARTS

ID	DESCRIZIONE / DESCRIPTION	71013GP cod	71013GPI cod	71823PK cod
1	Fondello Posteriore / End Cap	5009701	5009948	5009612
2	Fondello Posteriore Dx - Lat. / Right-lateral end cap			
3	Fondello Posteriore Sx-Sup. / Left-upper end cap			
4	Corpo Marmitta / Silencer Sleeve	5260552	5265001	5260517
5	Corpo Marmitta "dx" / Right Silencer Sleeve			
6	Corpo Marmitta "sx" / Left Silencer Sleeve			
7	Materiale fonoassorbente / Sound-absorbant material	5690106	5690106	5690096
8	Rivetto inox mm 4.8 / Stainless Steel 4.8 mm Rivet	3608011	3608011	3608011
9A	Rivetto allum.mm.3.0 / Aluminium 3.0 mm Rivet			3608010
9B	Rivetto allum.mm.3.0 nero / Black Aluminium 3.0 mm Rivet			3608016
10A	Fascetta di Serraggio (Posteriore) / Strap For Rivets (Rear)			5495179
10B	Fascetta di serraggio (Anteriore) / Strap For Rivets (Front)			5495151
11	Fascetta di Sostegno / Silencer Clamp	5480120	5480151	
12	Guarnizione x Fascetta / Clamp Gasket			
13	Copri Fascetta / Stainless Steel Clamp Protection			
14	Staffa di Sostegno / Bracket	5843278	5843278	
15	Staffa sostegno "Dx" / Right Bracket			
16	Staffa sostegno "Sx" / Left Bracket			
17	Inserto Rapid Nut / Rapid nut insert			
18	Molla lunga gancio tondo / Long Spring With Round Hook			
19	Molla lunga gancio ad "U" / Long Spring With "U" Hook	5281002	5281002	
20	Molla corta gancio tondo / Short spring with roud hook			
21	Molla corta gancio ad "U" / Short Spring With "U" Hook			
22	Targhetta Arrow / Arrow Plate	3882856		5855104
23	Silenziatore Interno / Db Killer			
24	Seeger / Retain Clip			
25	Fascetta Stringitubo / Pipe Clamp	3080016	3080016	3080016
26	Boccola / Bushing			
27	Flangia / Flange			
28	Protezione / Heat Shield			
29	Protezione Dx / Right heat shield			
30	Protezione Sx / Left heat shield			
31	Gommino Battuta Cavalletto / Rubber Kickstand Protection			
32	Guarnizione di tenuta / Gasket			
33	Tappo Sonda Lambda M18 / M18 Lambda Sensor Plug Bolt			
34	Fondello carby / Carby cap			5704051